



101D UTILITY GAUGE LOWER MOUNT

1 Utility gauge for commercial and industrial markets
Black steel case, chrome bezel, copper alloy internals

SPECIFICATIONS

Dial	1 ½" (40 mm), 2" (50 mm), 2 ½" (63 mm), 3 ½" (88 mm), 4 ½" (114 mm)
Case	Black steel, dry non-fillable
Wetted Parts	Copper alloy
Bezel	Chrome plated steel, fixed
Lens	Plastic (4 ½" = glass lens)
Pointer	Black aluminum
Connection	Lower mount 1 ½" dial = ⅛" NPT 2" dial = ⅛" or ¼" NPT 2 ½" dial = ¼" NPT 3 ½" dial = ¼" NPT 4 ½" dial = ¼" NPT
Scale	Standard: psi/BAR (x 100 = kPa) Single scale psi available from stock
Accuracy	3-2-3% of span, ASME B40.1 Grade B
Ambient Temp	-50° F to 160° F

Design meets or exceeds ASME B40.100 pressure gauge standard.

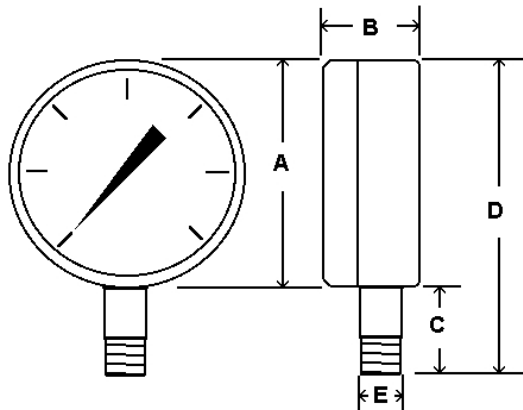

AVAILABLE OPTIONS*

- Certificate of Accuracy, NIST traceable
- Custom Dial
- Anti-Vibration Movement, see page 109
- Glass Lens
- Stainless Steel Case
- Cleaned for Oxygen Service
- Special Connection Size
- Protective Rubber Cover, see page 121
- Max/Min Pointer, see page 122

*Lead times/minimums may apply

APPROXIMATE SHIPPING WEIGHTS/ BOX QUANTITIES

Dial Size	Est. Unit Weight	Box Qty
1 ½"	0.20 lbs (0.10 kg)	200
2"	0.26 lbs (0.12 kg)	100
2 ½"	0.34 lbs (0.15 kg)	125
3 ½"	0.50 lbs (0.23 kg)	50
4 ½"	0.60 lbs (0.27 kg)	50

Dial	Unit	A	B	C	D	E
1 ½"	In.	1.64"	0.93"	0.65"	2.26"	⅛" NPT
	mm	42	24	17	57	
2"	In.	2.07"	1.06"	0.83"	2.83"	⅛" or ¼" NPT
	mm	53	27	21	72	
2 ½"	In.	2.5"	1.13"	0.88"	3.31"	¼" NPT
	mm	63	29	22	84	
3 ½"	In.	3.54"	1.12"	1.02"	4.49"	¼" NPT
	mm	90	28	26	114	
4 ½"	In.	4.79"	1.12"	1.10"	5.8"	¼" NPT
	mm	122	29	28	147	